



Refer to instruction manual/booklet.



Any horizontal surface which looks like a platform on a mobile platform ladder that is not designed for standing on (e.g. plastic work tray) will be clearly indicated on that surface.



Do not step off the side of the mobile platform ladder onto another surface.



Maximum total load.



Inspect the ladder after delivery. Before every use visually check the ladder is not damaged and is safe to use.



Do not use the ladder as a bridge.



Maximum number of users.



Do not overreach.

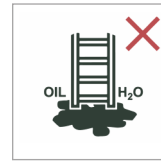

Do not erect ladder on contaminated ground.



Keep a secure grip on the ladder when ascending and descending. Maintain a handhold whilst working from a ladder or take additional safety precautions if you cannot.



Do not ascend/descend unless you are facing the ladder.

ALWAYS

- ✓ Prevent damage of the ladder when transporting e.g. by fastening and, ensure they are suitably placed to prevent damage.
- ✓ Ensure the ladder is suitable for the task.
- ✓ For professional use a risk assessment shall be carried out.
- ✓ When positioning the ladder take into account risk of collision with the ladder e.g. from pedestrians, vehicles or doors. Secure doors (not fire exits) and windows where possible in the work area.
- ✓ Use non-conductive ladders for unavoidable live electrical work.
- ✓ Always pay attention to wind conditions when using the ladder outdoors.



Fully open before use.



Do not carry equipment which is heavy or difficult to handle while using the ladder.

NEVER

- ✗ Do not spend long periods on a ladder without regular breaks.
- ✗ Do not use the ladder if contaminated, e.g. with wet paint, mud, oil or snow.
- ✗ Do not use the ladder outside in adverse weather conditions, such as a strong wind.
- ✗ Do not modify the ladder design.
- ✗ Do not move a ladder while standing on it.



Use only with stabilisers.



Do not use the ladder if you are not fit enough. Certain medical conditions or medication, alcohol or drug abuse could make ladder use unsafe.



Ladder for Professional use.

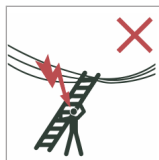

Identify any electrical risks in the work area, such as overhead lines or other exposed electrical equipment and do not use the ladder where electrical risks occur.



Ladder for Domestic use.



Do not use the ladder on an unlevel or infirm base.



Avoid work that imposes a sideways load on ladders, such as side-on drilling through solid materials.



Do not wear unsuitable footwear when climbing a ladder.



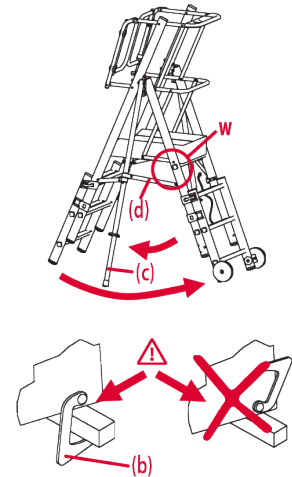
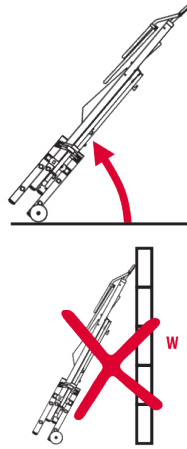
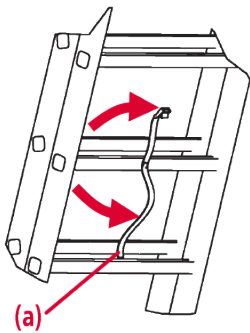

1 Release transport strap by pressing the catch lock and pulling the strap through the buckle.

2 Stand the ladder upright.
Never lean ladder against walls with the transport wheel in contact with the ground.

3 Open ladder out ensuring the platform deck rests against the top rear rung. The platform deck safety hook (b) should be applied as shown above. Pull out stabilisers (c) ensuring safety bars (d) are fully locked.

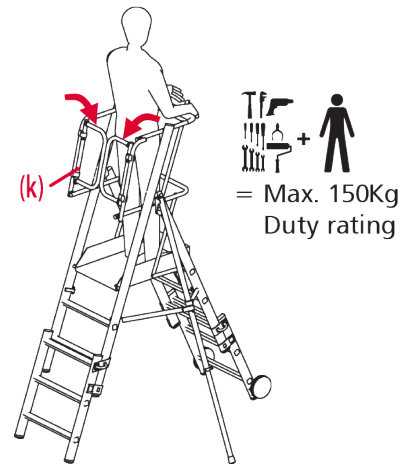
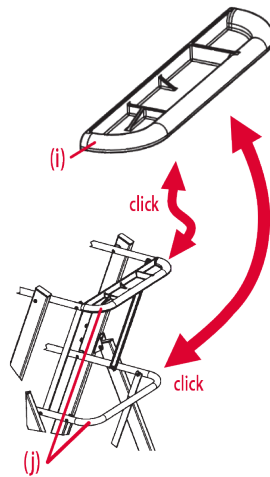
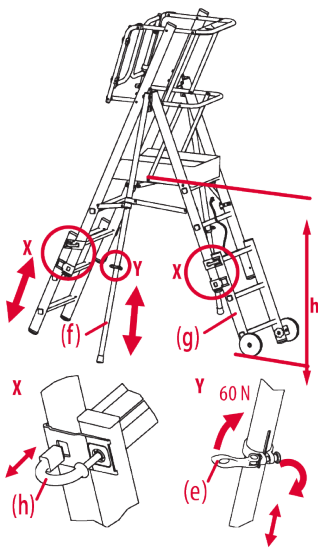

4 Loosen Quick-Clamp (e) and slide out stabiliser leg (f) until the foot is in contact with the ground. Tighten Quick-Clamp as shown above. Platform deck height can be adjusted by extending the telescopic ladder sections (g). Pull out Quick-Lock pins (h) on one section, push ladder up one rung and re-insert Quick-Lock pins. Repeat on opposite section. Repeat process until desired platform deck height is achieved. Re-adjust stabiliser length so stabiliser foot is in contact with the ground.

5 The tooltray (i) can be clicked into place on either the upper or mid safety rails (j) as shown above.

6 Complete a visual check of the ladder and its components before accessing the platform deck. Ensure the spring loaded safety gates (k) are fully closed once inside the platform deck area. Periodic checks of the ladder for correct functionality and damage should be carried out by competent personnel.